

- 1
- 2
- 3
- 4
- 5
- 6
- 7
- 8
- 9
- 10
- 11
- 12
- 13
- 14
- 15
- 16
- 17
- 18
- 19

PERNO

Acciaio INOX AISI 303.

DENTI DI FISSAGGIO

Acciaio INOX AISI 304.

MOLLA

Acciaio INOX AISI 301.

MANOPOLA E PULSANTE

Acciaio INOX AISI 303.

CARATTERISTICHE E APPLICAZIONI

I perni autobloccanti in acciaio INOX GN 114.6 sono generalmente usati per fissaggi rapidi fra componenti o parti di lavorazione, in particolare quando devono continuamente essere rimossi e riposizionati.

ACCESSORI

Per ottimizzare l'impiego di questi perni autobloccanti sono disponibili:

- catenelle a sfere GN 111 (vedi pag. 611);
- cavetti di ritegno GN 111.2 (vedi pag. 612);
- cavetti di ritegno a spirale GN 111.4 (vedi pag. 613).

ISTRUZIONI D'USO

Effettuando una pressione sul pulsante i due denti vengono liberati consentendo di inserire o disinserire il perno di bloccaggio.



Esempio di applicazione

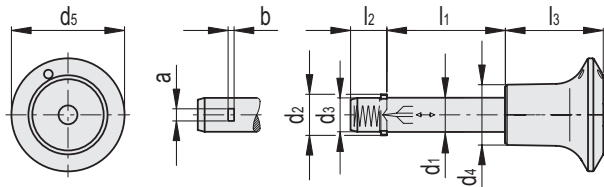
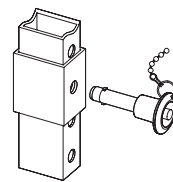

INOX STAINLESS STEEL

Codice	Descrizione	d1 -0.1	d2	d3	d4	d5	l1 +2	l2	l3	a	b	Resistenza al taglio [KN]	⚖️
GN.38871	GN 114.6-6-16	6	7.3	5.9	12	25	16	7	20	2.3	0.5	17	33
GN.38873	GN 114.6-6-20	6	7.3	5.9	12	25	20	7	20	2.3	0.5	17	34
GN.38875	GN 114.6-6-25	6	7.3	5.9	12	25	25	7	20	2.3	0.5	17	35
GN.38877	GN 114.6-6-30	6	7.3	5.9	12	25	30	7	20	2.3	0.5	17	36
GN.78401	GN 114.6-6-35	6	7.3	5.9	12	25	35	7	20	2.3	0.5	17	36
GN.38879	GN 114.6-6-40	6	7.3	5.9	12	25	40	7	20	2.3	0.5	17	38
GN.78402	GN 114.6-6-45	6	7.3	5.9	12	25	45	7	20	2.3	0.5	17	40
GN.78403	GN 114.6-6-50	6	7.3	5.9	12	25	50	7	20	2.3	0.5	17	40
GN.78404	GN 114.6-6-60	6	7.3	5.9	12	25	60	7	20	2.3	0.5	17	46
GN.78405	GN 114.6-6-70	6	7.3	5.9	12	25	70	7	20	2.3	0.5	17	50
GN.78406	GN 114.6-6-80	6	7.3	5.9	12	25	80	7	20	2.3	0.5	17	52
GN.78411	GN 114.6-8-16	8	9.8	7.9	15	30	16	8.4	21	2.8	0.6	35	53
GN.38881	GN 114.6-8-20	8	9.8	7.9	15	30	20	8.4	21	2.8	0.6	35	54
GN.38883	GN 114.6-8-25	8	9.8	7.9	15	30	25	8.4	21	2.8	0.6	35	57
GN.38885	GN 114.6-8-30	8	9.8	7.9	15	30	30	8.4	21	2.8	0.6	35	59
GN.78412	GN 114.6-8-35	8	9.8	7.9	15	30	35	8.4	21	2.8	0.6	35	60
GN.38887	GN 114.6-8-40	8	9.8	7.9	15	30	40	8.4	21	2.8	0.6	35	62
GN.78413	GN 114.6-8-45	8	9.8	7.9	15	30	45	8.4	21	2.8	0.6	35	65
GN.38889	GN 114.6-8-50	8	9.8	7.9	15	30	50	8.4	21	2.8	0.6	35	66
GN.78414	GN 114.6-8-60	8	9.8	7.9	15	30	60	8.4	21	2.8	0.6	35	73
GN.78415	GN 114.6-8-70	8	9.8	7.9	15	30	70	8.4	21	2.8	0.6	35	75
GN.78416	GN 114.6-8-80	8	9.8	7.9	15	30	80	8.4	21	2.8	0.6	35	80
GN.78417	GN 114.6-8-90	8	9.8	7.9	15	30	90	8.4	21	2.8	0.6	35	84
GN.78418	GN 114.6-8-100	8	9.8	7.9	15	30	100	8.4	21	2.8	0.6	35	86

Elementi di posizionamento

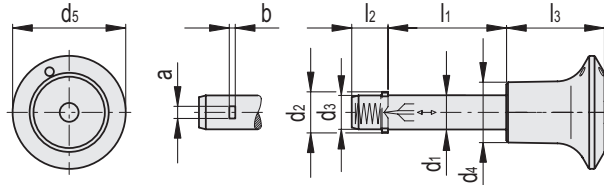

INOX STAINLESS STEEL

Codice	Descrizione	d1 -0.1	d2	d3	d4	d5	l1+2	l2	l3	a	b	Resistenza al taglio [KN]	⚖
GN.38893	GN 114.6-10-25	10	11.7	9.9	18	34	25	9.8	26	3.3	1	47	90
GN.38895	GN 114.6-10-30	10	11.7	9.9	18	34	30	9.8	26	3.3	1	47	93
GN.78422	GN 114.6-10-35	10	11.7	9.9	18	34	35	9.8	26	3.3	1	47	94
GN.38897	GN 114.6-10-40	10	11.7	9.9	18	34	40	9.8	26	3.3	1	47	99
GN.78423	GN 114.6-10-45	10	11.7	9.9	18	34	45	9.8	26	3.3	1	47	103
GN.38899	GN 114.6-10-50	10	11.7	9.9	18	34	50	9.8	26	3.3	1	47	106
GN.78424	GN 114.6-10-60	10	11.7	9.9	18	34	60	9.8	26	3.3	1	47	111
GN.78425	GN 114.6-10-70	10	11.7	9.9	18	34	70	9.8	26	3.3	1	47	116
GN.78426	GN 114.6-10-80	10	11.7	9.9	18	34	80	9.8	26	3.3	1	47	122
GN.78427	GN 114.6-10-90	10	11.7	9.9	18	34	90	9.8	26	3.3	1	47	128
GN.78428	GN 114.6-10-100	10	11.7	9.9	18	34	100	9.8	26	3.3	1	47	134
GN.78429	GN 114.6-10-110	10	11.7	9.9	18	34	110	9.8	26	3.3	1	47	140
GN.78430	GN 114.6-10-120	10	11.7	9.9	18	34	120	9.8	26	3.3	1	47	146
GN.78441	GN 114.6-12-20	12	13.7	11.9	18	34	20	11.3	26	3.8	1	75	94
GN.38901	GN 114.6-12-25	12	13.7	11.9	18	34	25	11.3	26	3.8	1	75	99
GN.38903	GN 114.6-12-30	12	13.7	11.9	18	34	30	11.3	26	3.8	1	75	104
GN.78442	GN 114.6-12-35	12	13.7	11.9	18	34	35	11.3	26	3.8	1	75	109
GN.38905	GN 114.6-12-40	12	13.7	11.9	18	34	40	11.3	26	3.8	1	75	112
GN.78443	GN 114.6-12-45	12	13.7	11.9	18	34	45	11.3	26	3.8	1	75	117
GN.38907	GN 114.6-12-50	12	13.7	11.9	18	34	50	11.3	26	3.8	1	75	121
GN.38909	GN 114.6-12-60	12	13.7	11.9	18	34	60	11.3	26	3.8	1	75	120
GN.78444	GN 114.6-12-70	12	13.7	11.9	18	34	70	11.3	26	3.8	1	75	138
GN.78445	GN 114.6-12-80	12	13.7	11.9	18	34	80	11.3	26	3.8	1	75	150
GN.78446	GN 114.6-12-90	12	13.7	11.9	18	34	90	11.3	26	3.8	1	75	155
GN.78447	GN 114.6-12-100	12	13.7	11.9	18	34	100	11.3	26	3.8	1	75	164
GN.78448	GN 114.6-12-110	12	13.7	11.9	18	34	110	11.3	26	3.8	1	75	172
GN.78449	GN 114.6-12-120	12	13.7	11.9	18	34	120	11.3	26	3.8	1	75	181
GN.38911	GN 114.6-16-30	16	18.7	15.9	22	40	30	14.2	32	4.8	1.2	138	181
GN.38913	GN 114.6-16-35	16	18.7	15.9	22	40	35	14.2	32	4.8	1.2	138	188
GN.38915	GN 114.6-16-40	16	18.7	15.9	22	40	40	14.2	32	4.8	1.2	138	196
GN.78451	GN 114.6-16-45	16	18.7	15.9	22	40	45	14.2	32	4.8	1.2	138	203
GN.38917	GN 114.6-16-50	16	18.7	15.9	22	40	50	14.2	32	4.8	1.2	138	212
GN.38919	GN 114.6-16-60	16	18.7	15.9	22	40	60	14.2	32	4.8	1.2	138	226
GN.78452	GN 114.6-16-70	16	18.7	15.9	22	40	70	14.2	32	4.8	1.2	138	242
GN.38921	GN 114.6-16-80	16	18.7	15.9	22	40	80	14.2	32	4.8	1.2	138	258
GN.78453	GN 114.6-16-90	16	18.7	15.9	22	40	90	14.2	32	4.8	1.2	138	272
GN.78454	GN 114.6-16-100	16	18.7	15.9	22	40	100	14.2	32	4.8	1.2	138	288
GN.78455	GN 114.6-16-110	16	18.7	15.9	22	40	110	14.2	32	4.8	1.2	138	303
GN.78456	GN 114.6-16-120	16	18.7	15.9	22	40	120	14.2	32	4.8	1.2	138	319
GN.78457	GN 114.6-16-130	16	18.7	15.9	22	40	130	14.2	32	4.8	1.2	138	334
GN.78458	GN 114.6-16-140	16	18.7	15.9	22	40	140	14.2	32	4.8	1.2	138	349
GN.78459	GN 114.6-16-150	16	18.7	15.9	22	40	150	14.2	32	4.8	1.2	138	365



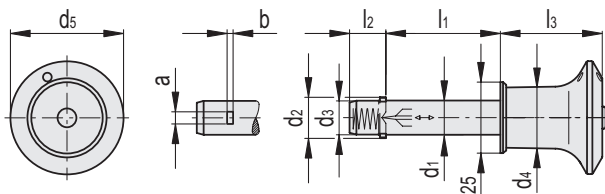
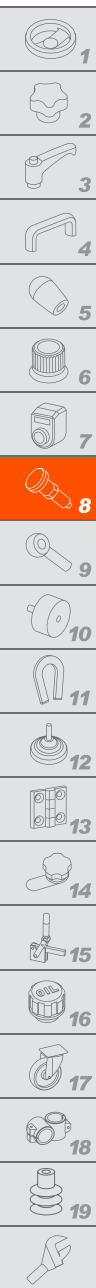

INOX STAINLESS STEEL

Codice	Descrizione	d1 -0.1	d2	d3	d4	d5	l1 +2	l2	l3	a	b	Resistenza al taglio [KN]	
GN.38931	GN 114.6-20-30	20	22.7	19.8	25	40	30	14.8	33	4.8	1.2	228	219
GN.38932	GN 114.6-20-35	20	22.7	19.8	25	40	35	14.8	33	4.8	1.2	228	228
GN.38933	GN 114.6-20-40	20	22.7	19.8	25	40	40	14.8	33	4.8	1.2	228	241
GN.78461	GN 114.6-20-45	20	22.7	19.8	25	40	45	14.8	33	4.8	1.2	228	256
GN.38934	GN 114.6-20-50	20	22.7	19.8	25	40	50	14.8	33	4.8	1.2	228	266
GN.38935	GN 114.6-20-60	20	22.7	19.8	25	40	60	14.8	33	4.8	1.2	228	293
GN.38936	GN 114.6-20-70	20	22.7	19.8	25	40	70	14.8	33	4.8	1.2	228	314
GN.38937	GN 114.6-20-80	20	22.7	19.8	25	40	80	14.8	33	4.8	1.2	228	330
GN.78462	GN 114.6-20-90	20	22.7	19.8	25	40	90	14.8	33	4.8	1.2	228	361
GN.78463	GN 114.6-20-100	20	22.7	19.8	25	40	100	14.8	33	4.8	1.2	228	383
GN.78464	GN 114.6-20-110	20	22.7	19.8	25	40	110	14.8	33	4.8	1.2	228	405
GN.78465	GN 114.6-20-120	20	22.7	19.8	25	40	120	14.8	33	4.8	1.2	228	427
GN.78466	GN 114.6-20-130	20	22.7	19.8	25	40	130	14.8	33	4.8	1.2	228	450
GN.78467	GN 114.6-20-140	20	22.7	19.8	25	40	140	14.8	33	4.8	1.2	228	472
GN.78468	GN 114.6-20-150	20	22.7	19.8	25	40	150	14.8	33	4.8	1.2	228	494

Elementi di posizionamento

3